

Legend

Area of Infestation (sq meters)

- 3 - 250
- 251 - 800
- 801 - 1875
- 1876 - 3300
- 3301 - 7200
- ▲ Small Patches
- Gales Creek
- Taxlots
- 100 Year Floodplain
- Streets

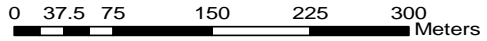

Area of Infestation in square meters (map 1)

Map shows the distribution of the total area of Japanese knotweed in the southernmost portion of the study area. The next 8 maps continue northwards, upstream on Gales Creek.

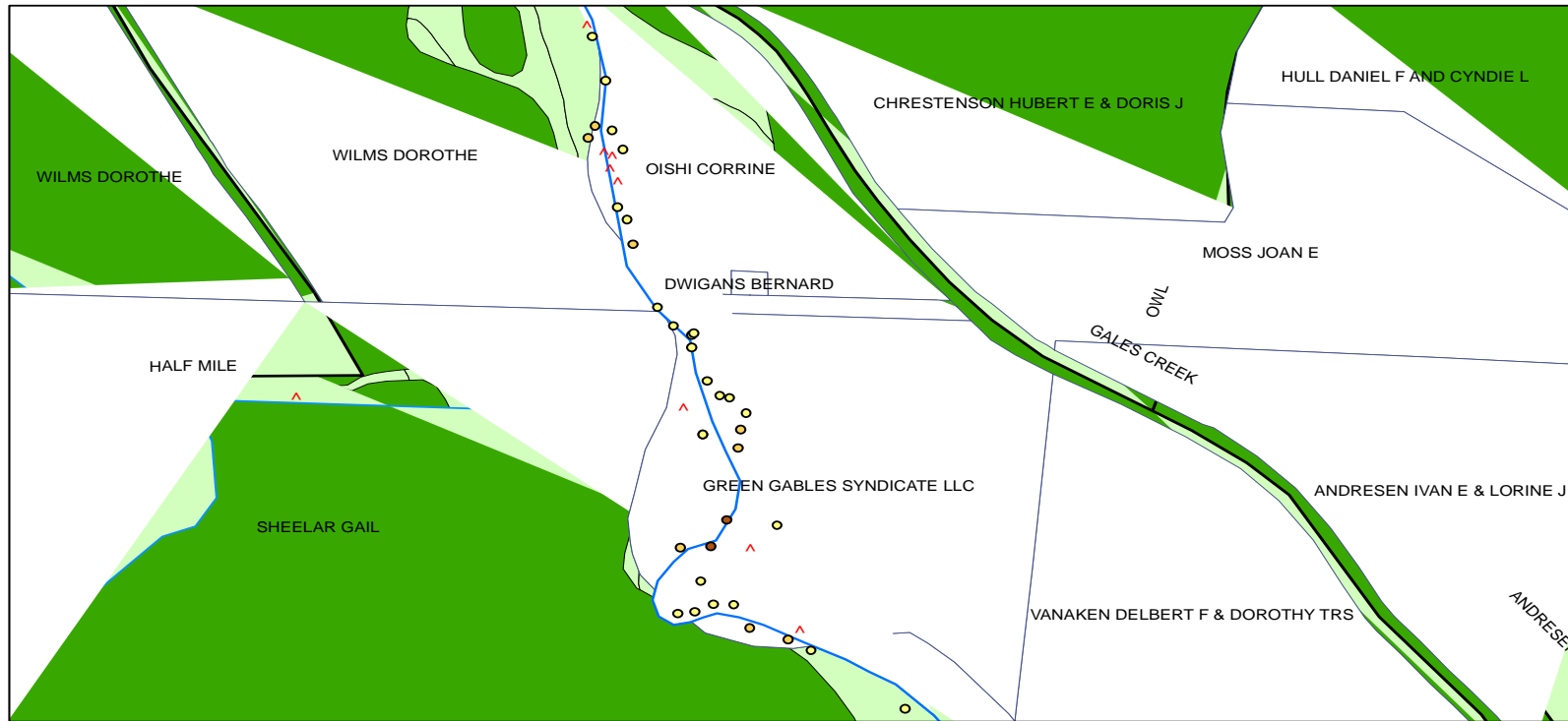

Legend

Area of Infestation (sq meters)

- 3 - 250
- 251 - 800
- 801 - 1875
- 1876 - 3300
- 3301 - 7200
- △ Small Patches
- Gales Creek
- Taxlots
- 100 Year Floodplain
- Streets

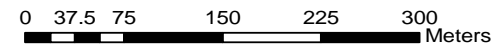

Area of Infestation in square meters (map 2)

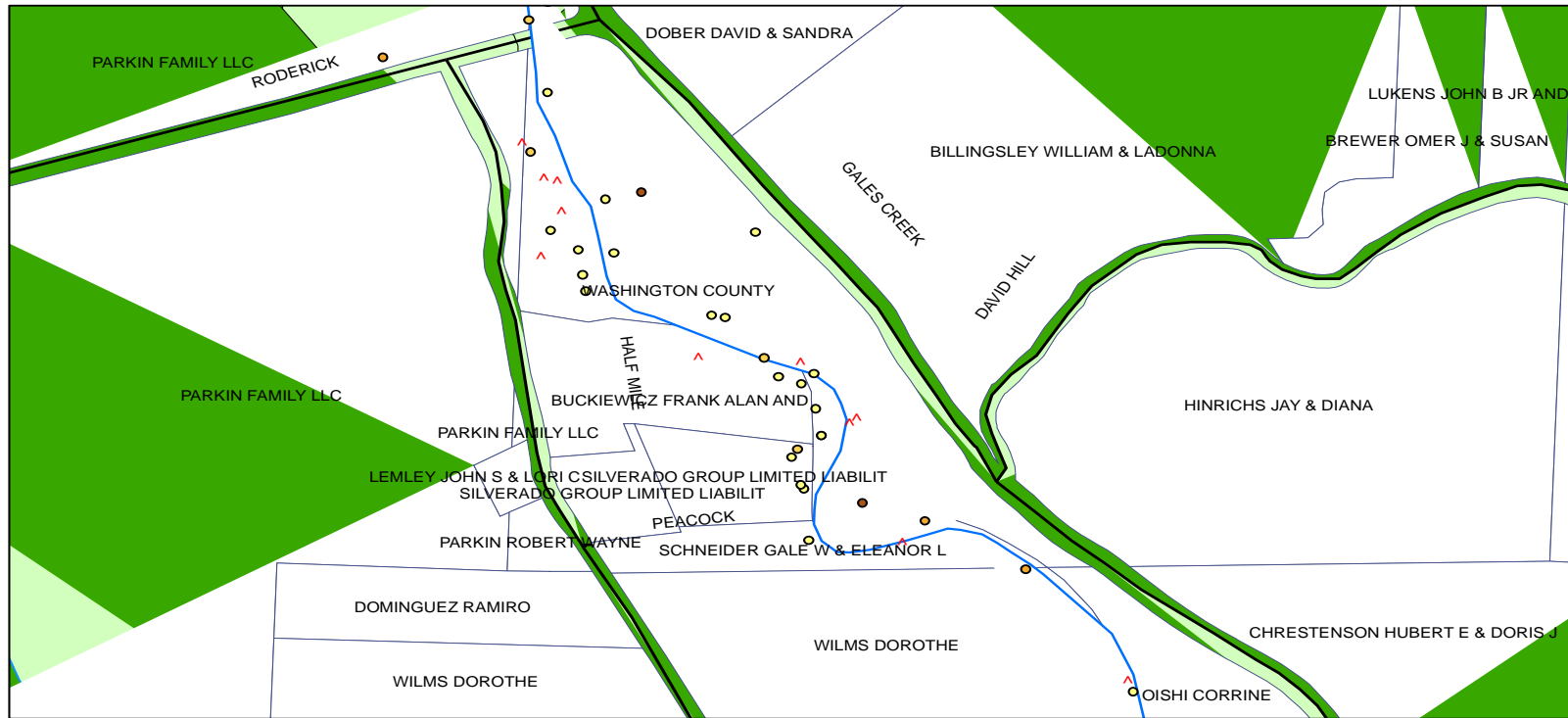

Legend

Area of Infestation (sq meters)

- 3 - 250
- 251 - 800
- 801 - 1875
- 1876 - 3300
- 3301 - 7200
- ▲ Small Patches
- Gales Creek
- Taxlots
- 100 Year Floodplain
- Streets

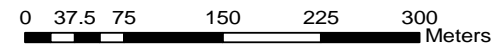

Area of Infestation in square meters (map 3)

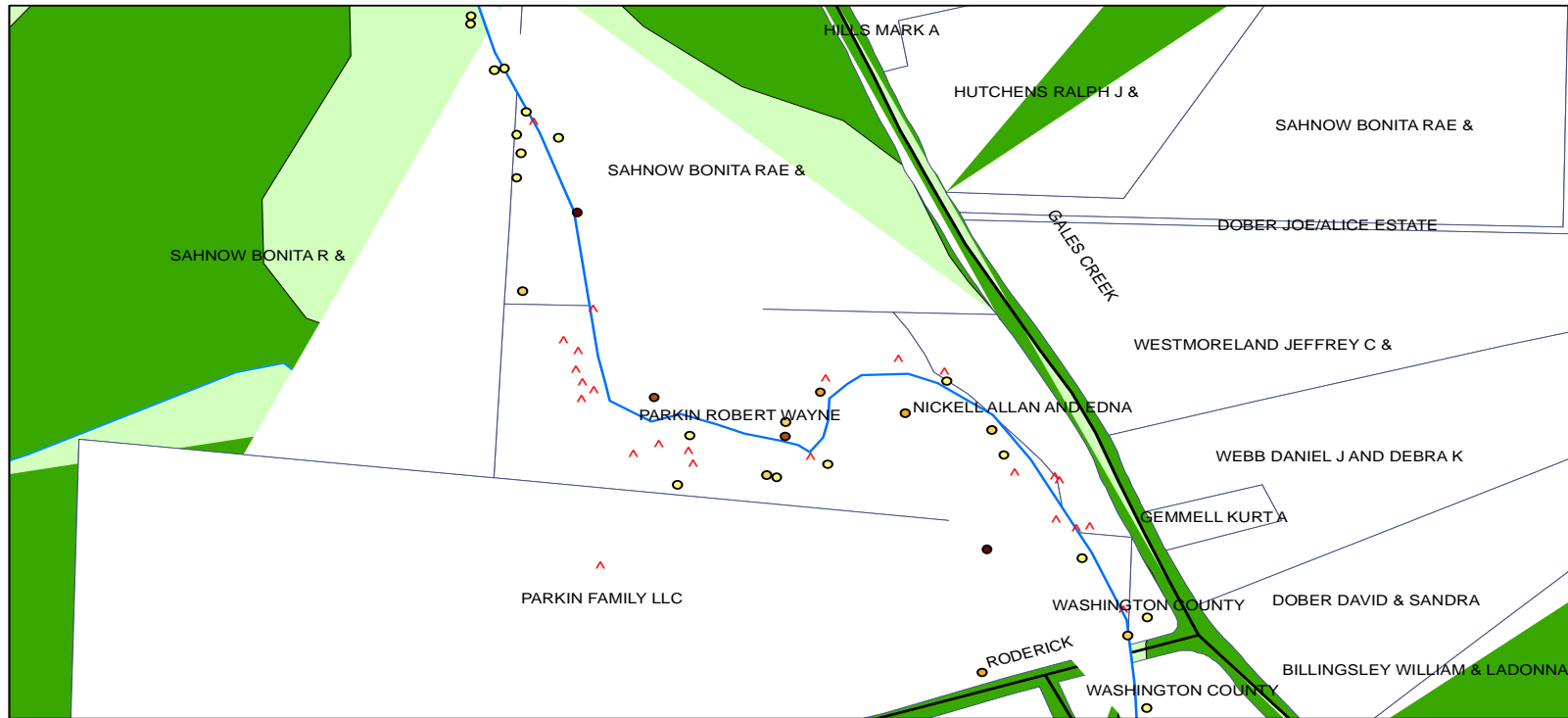

Legend

Area of Infestation (sq meters)

- 3 - 250
- 251 - 800
- 801 - 1875
- 1876 - 3300
- 3301 - 7200
- ▲ Small Patches
- Gales Creek
- Taxlots
- 100 Year Floodplain
- Streets

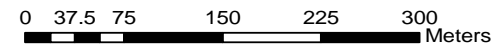

Area of Infestation in square meters (map 4)

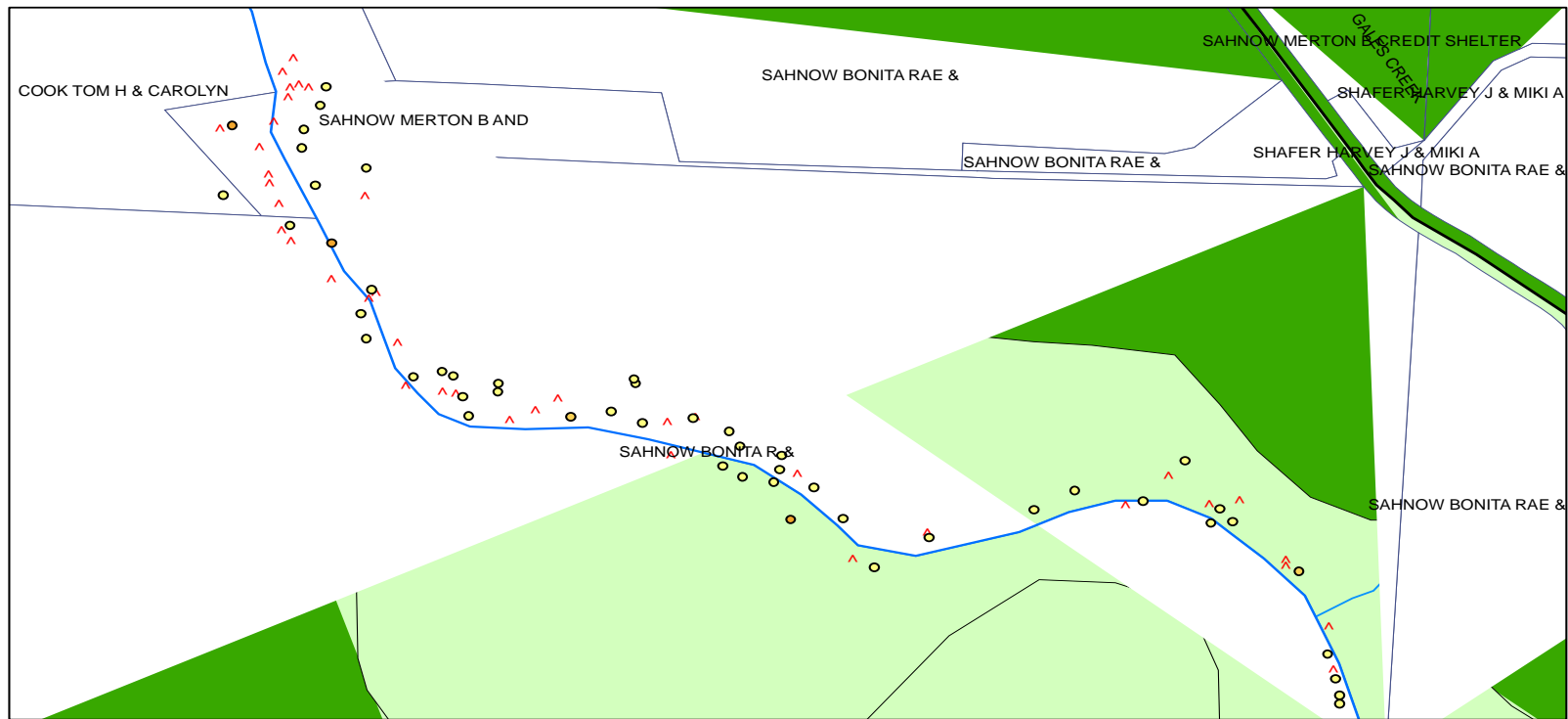

Legend

Area of Infestation (sq meters)

- 3 - 250
- 251 - 800
- 801 - 1875
- 1876 - 3300
- 3301 - 7200
- ▲ Small Patches

- Gales Creek
- Taxlots
- 100 Year Floodplain
- Streets

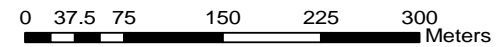

Area of Infestation in square meters (map 5)

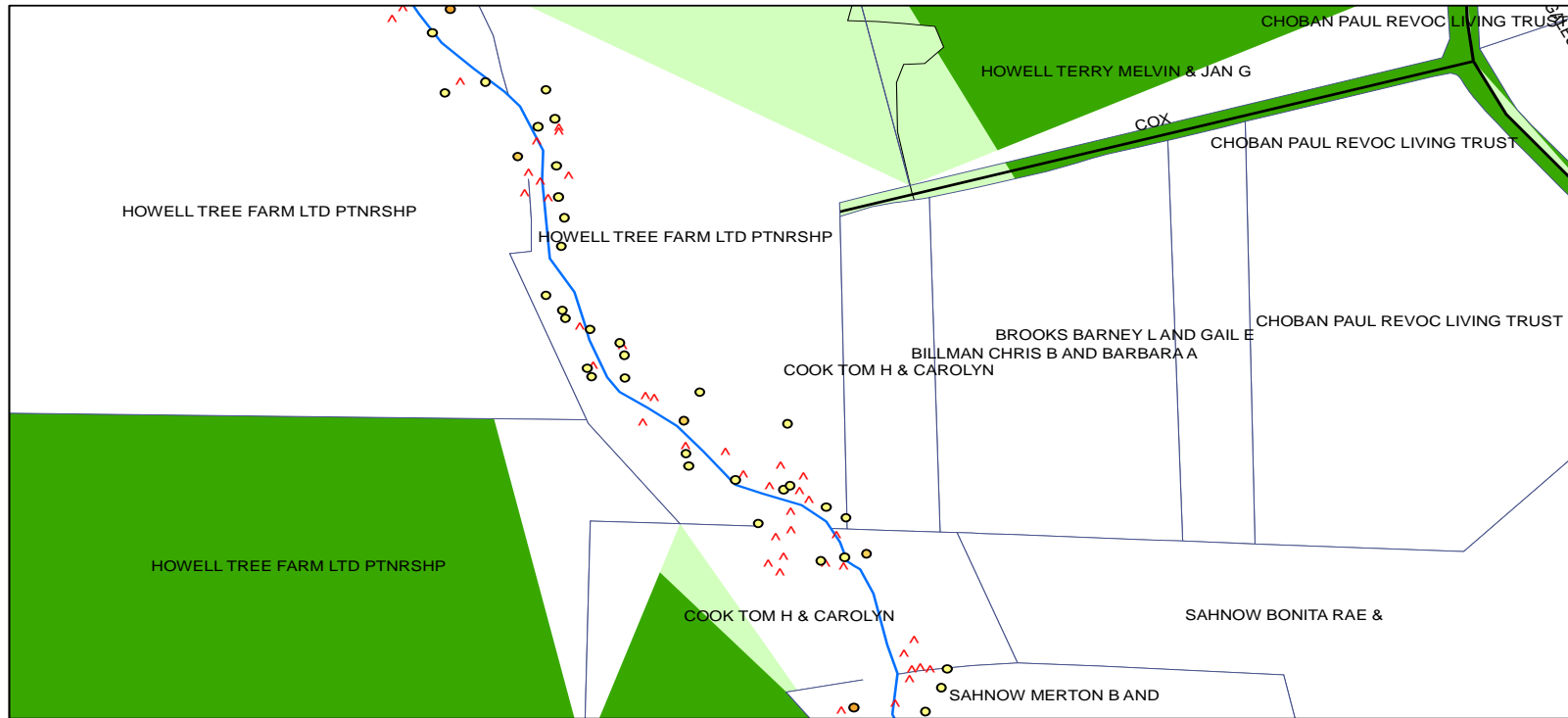

Legend

Area of Infestation (sq meters)

- 3 - 250
- 251 - 800
- 801 - 1875
- 1876 - 3300
- 3301 - 7200
- ▲ Small Patches
- Gales Creek
- Taxlots
- 100 Year Floodplain
- Streets

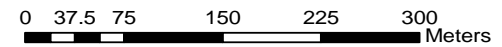

Area of Infestation in square meters (map 6)

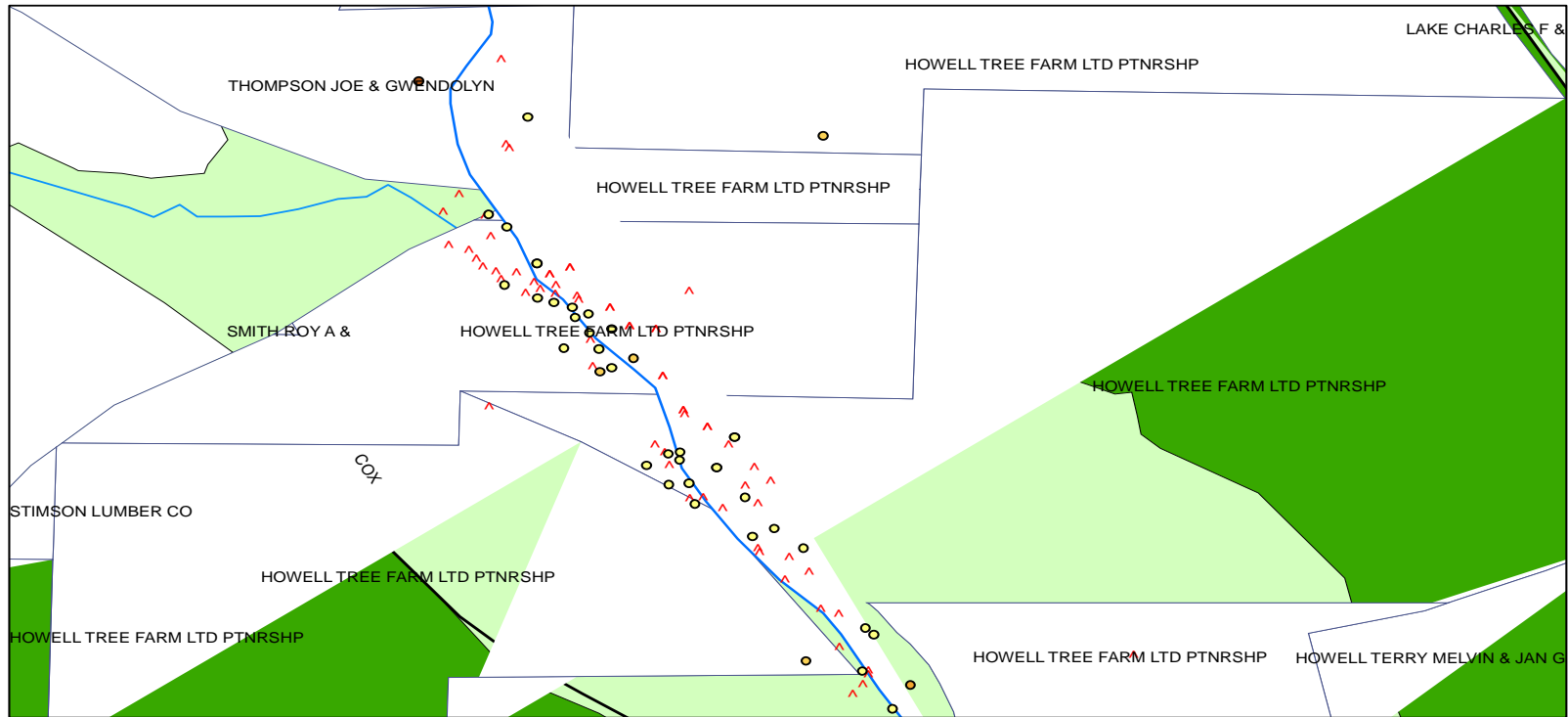

Legend

Area of Infestation (sq meters)

- 3 - 250
- 251 - 800
- 801 - 1875
- 1876 - 3300
- 3301 - 7200
- ▲ Small Patches
- Gales Creek
- Taxlots
- 100 Year Floodplain
- Streets

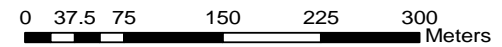

Area of Infestation in square meters (map 7)

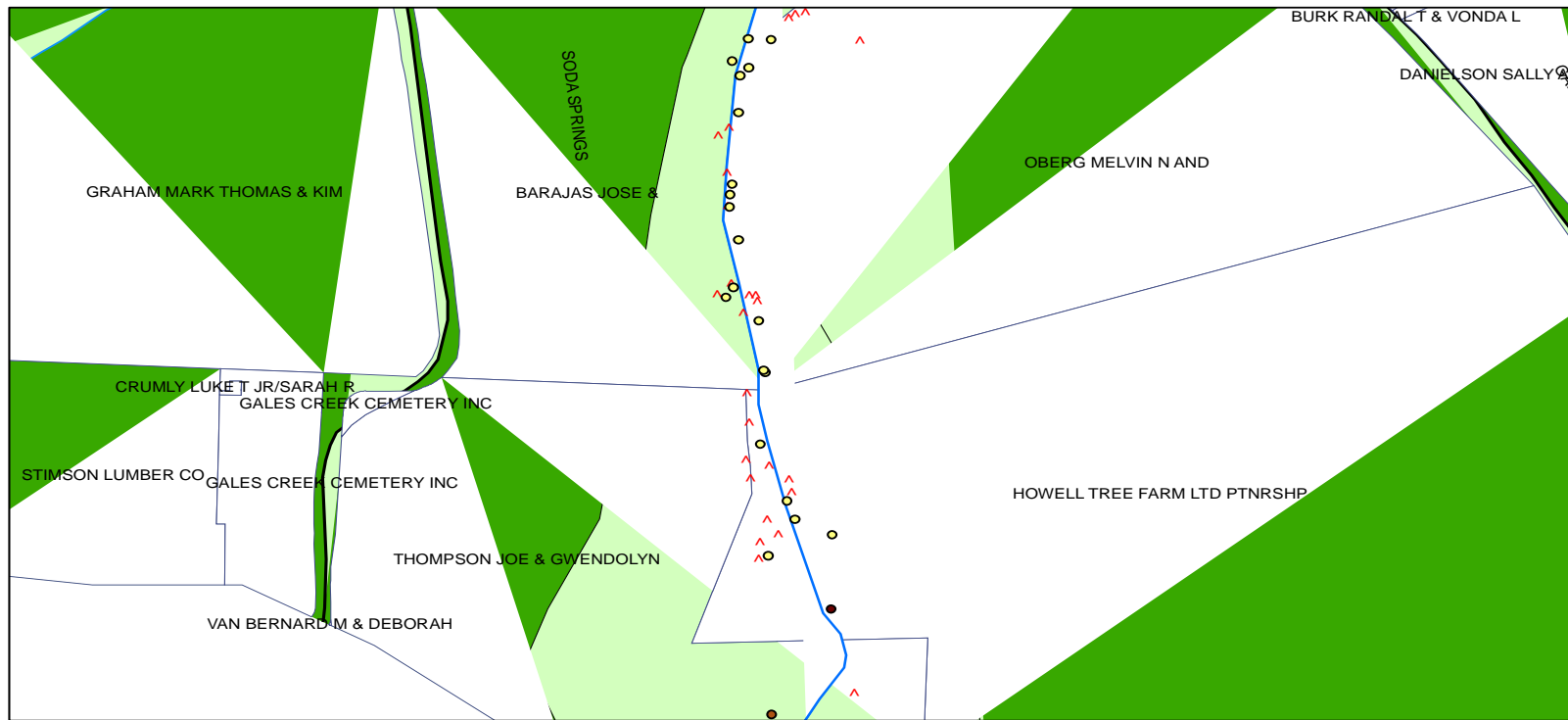

Legend

Area of Infestation (sq meters)

- 3 - 250
- 251 - 800
- 801 - 1875
- 1876 - 3300
- 3301 - 7200
- ^ Small Patches
- Gales Creek
- Taxlots
- 100 Year Floodplain
- Streets

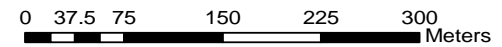

Area of Infestation in square meters (map 8)

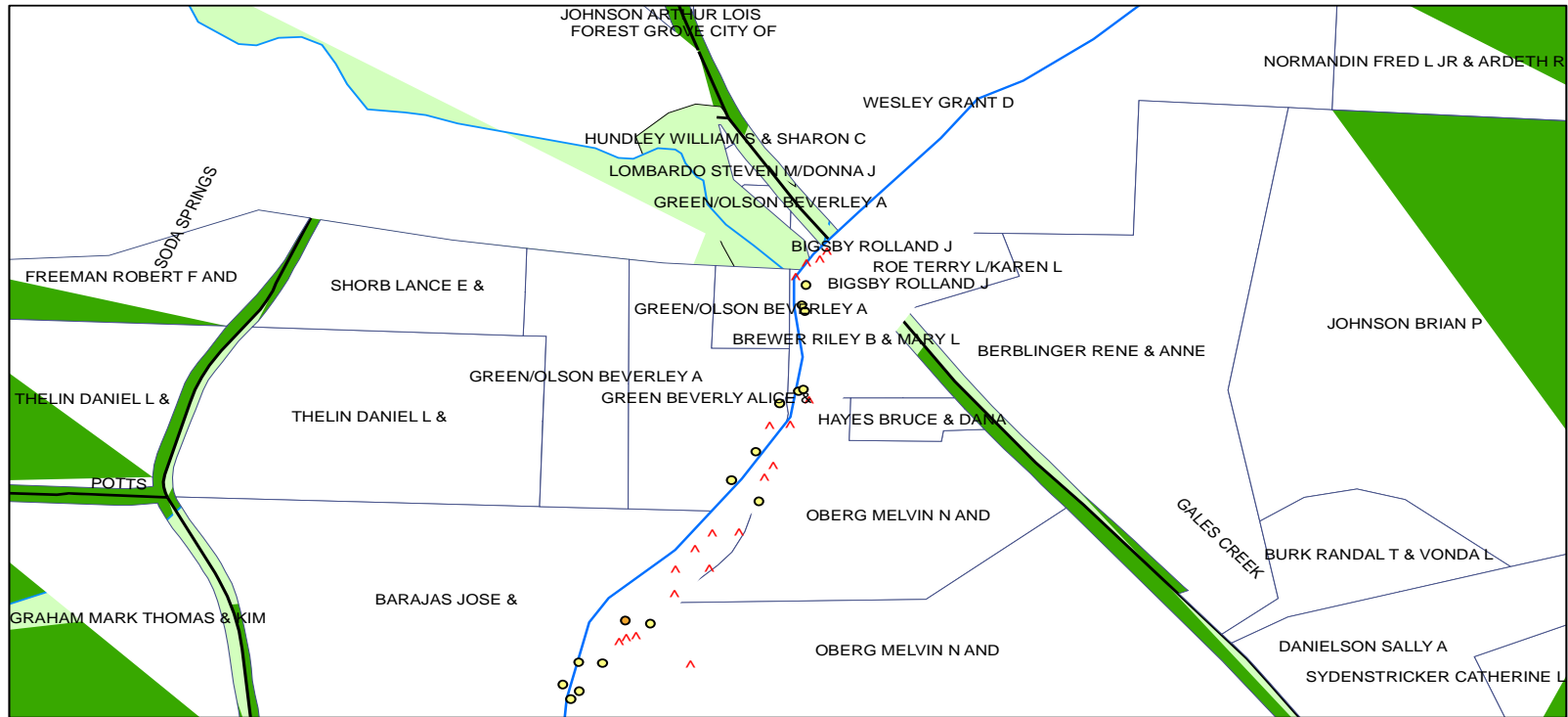

Legend

Area of Infestation (sq meters)

- 3 - 250
- 251 - 800
- 801 - 1875
- 1876 - 3300
- 3301 - 7200
- ▲ Small Patches
- Gales Creek
- Taxlots
- 100 Year Floodplain
- Streets

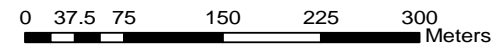

Area of Infestation in square meters (map 9)

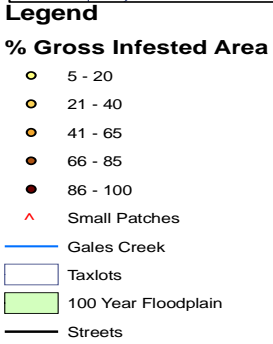
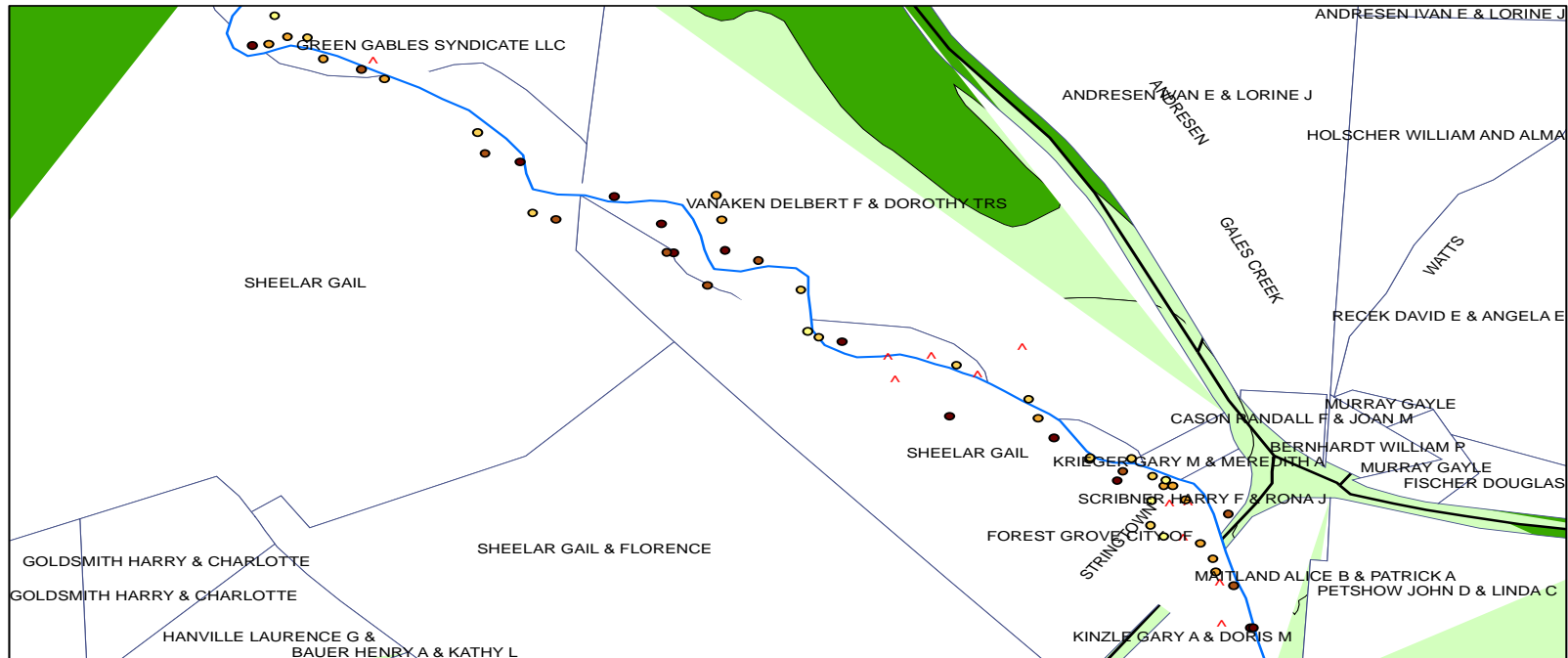

% Gross Infested Area (map 1)

Map shows the percentage of knotweed infestation in the southernmost portion of the study area. The next 8 maps continue northwards, upstream on Gales Creek.

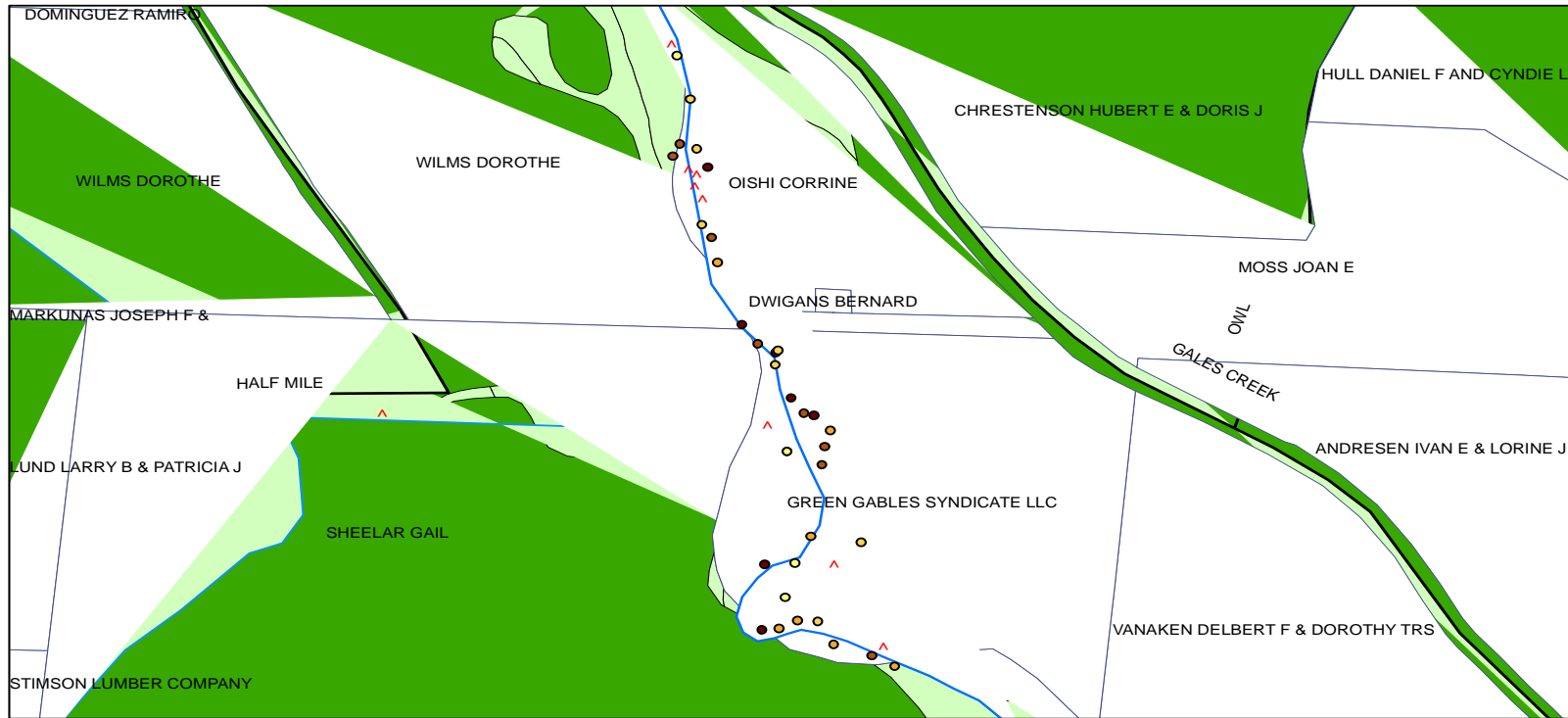

Legend

% Gross Infested Area

- 5 - 20
- 21 - 40
- 41 - 65
- 66 - 85
- 86 - 100
- ▲ Small Patches
- Gales Creek
- Taxlots
- 100 Year Floodplain
- Streets

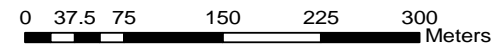

% Gross Infested Area (map 2)

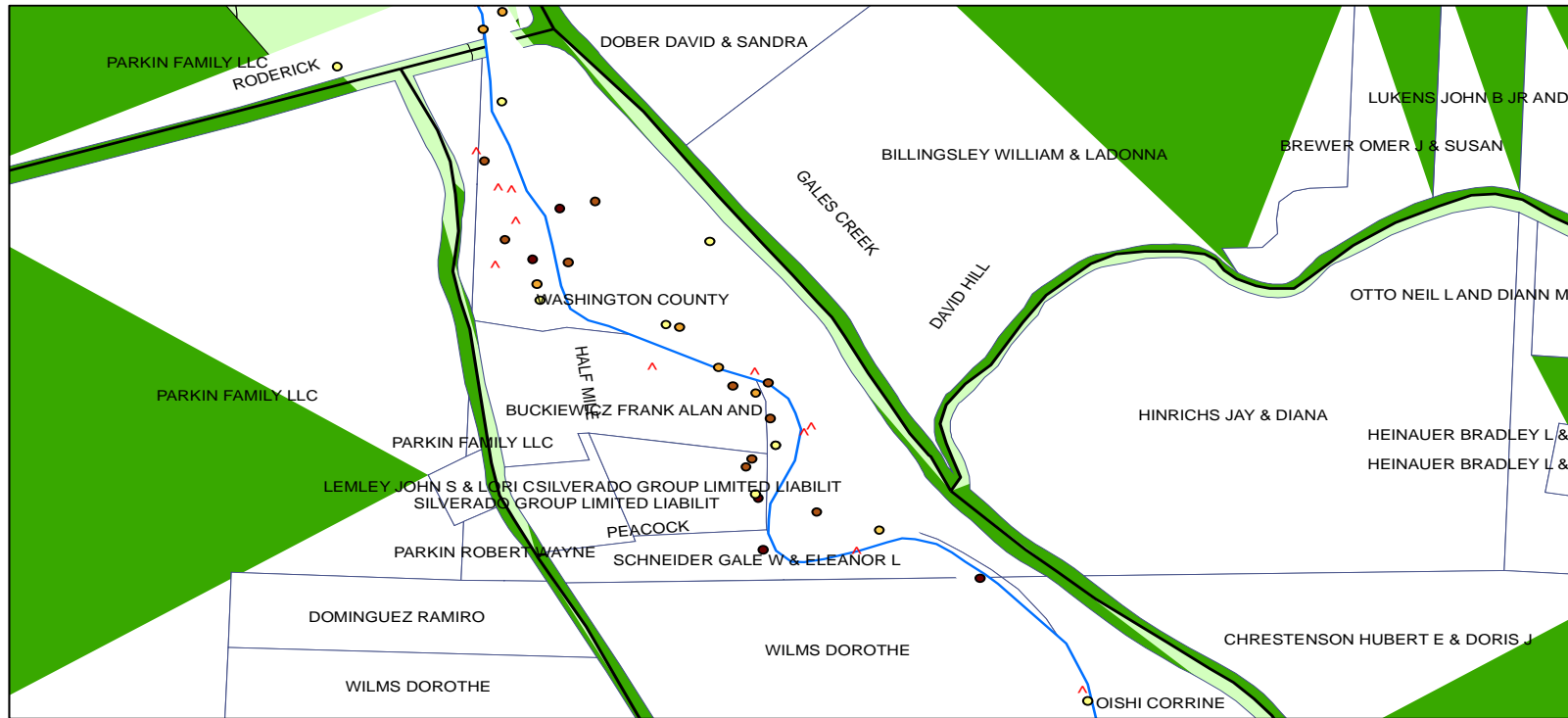

Legend

% Gross Infested Area

- 5 - 20
- 21 - 40
- 41 - 65
- 66 - 85
- 86 - 100
- ▲ Small Patches
- Gales Creek
- Taxlots
- 100 Year Floodplain
- Streets

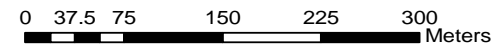

% Gross Infested Area (map 3)

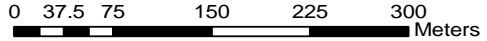
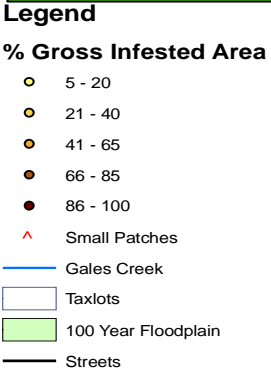
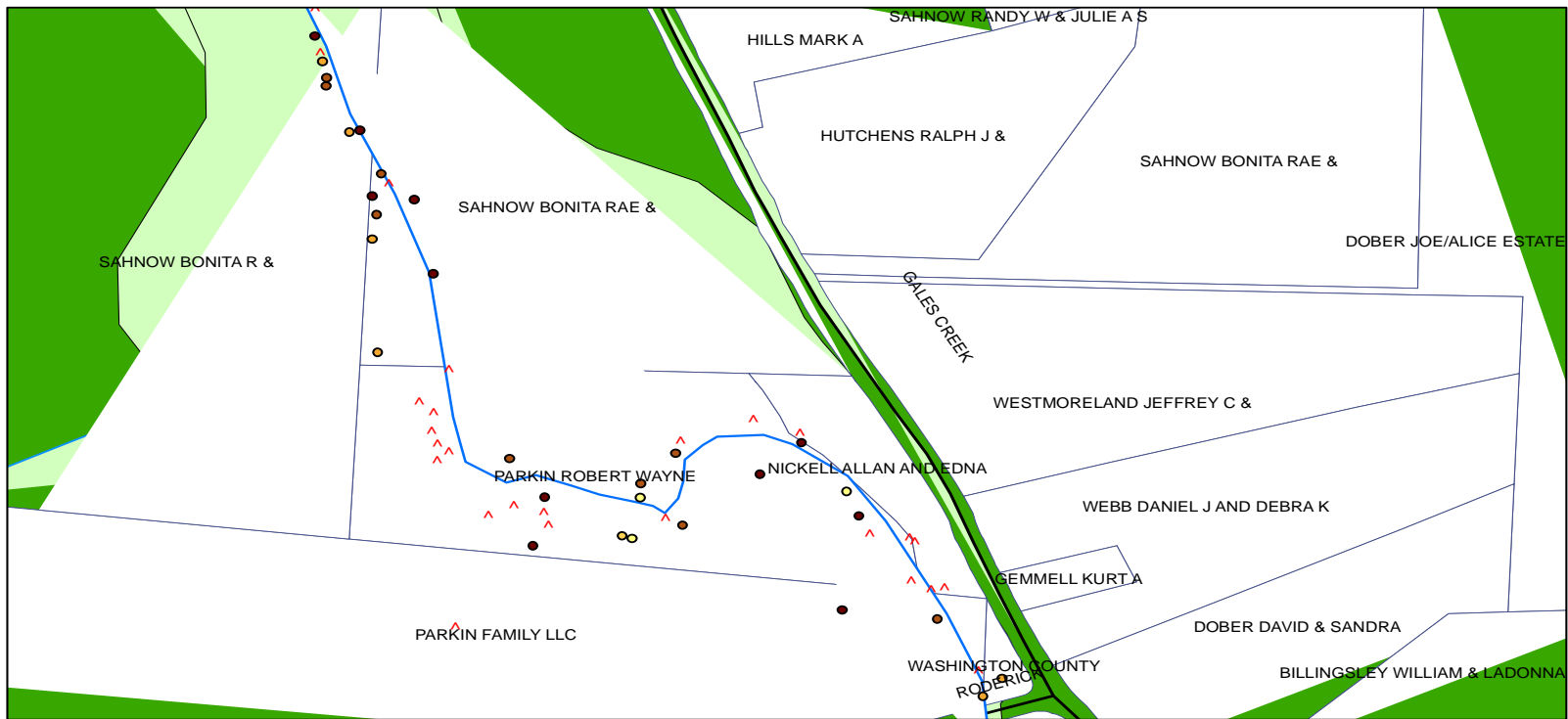

% Gross Infested Area (map 4)

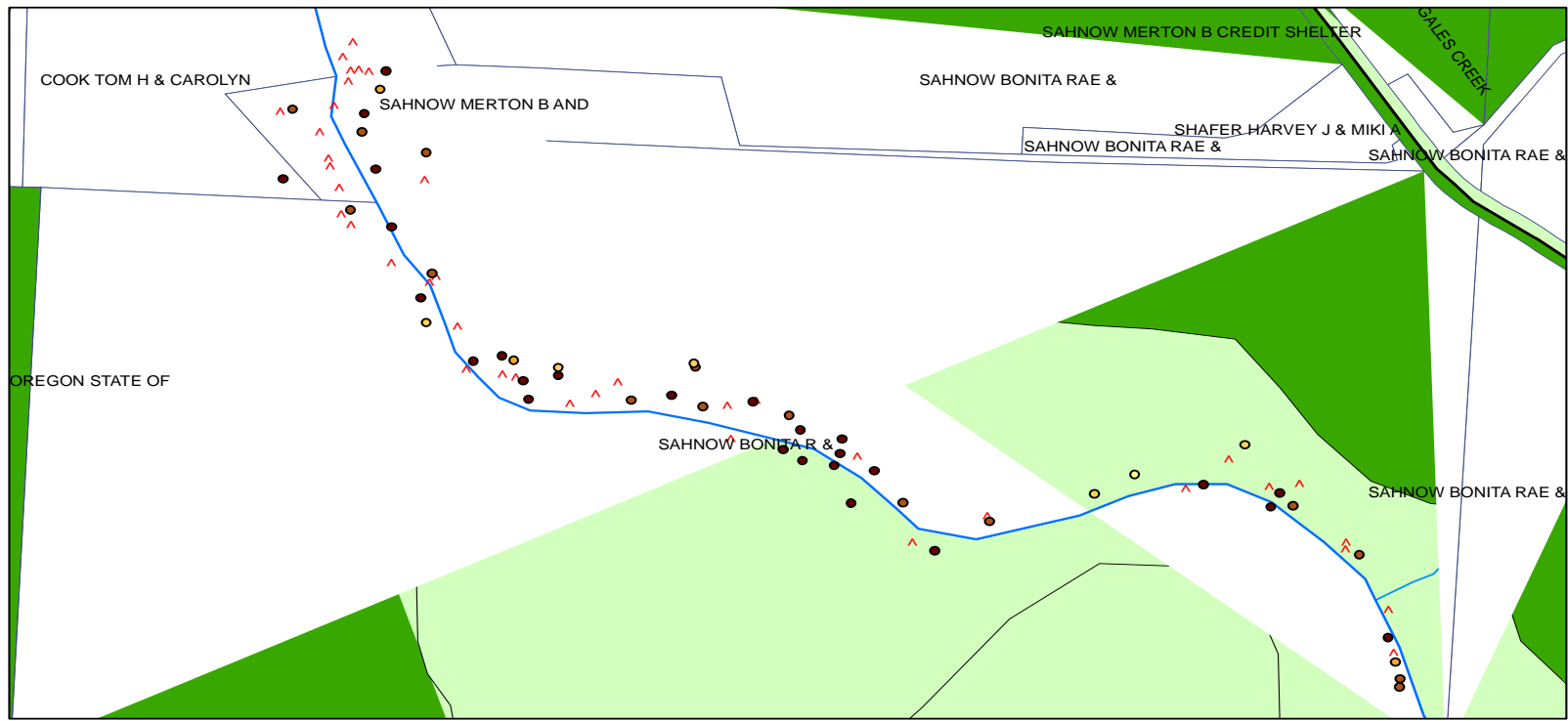

Legend

% Gross Infested Area

- 5 - 20
- 21 - 40
- 41 - 65
- 66 - 85
- 86 - 100
- △ Small Patches
- Gales Creek
- Taxlots
- 100 Year Floodplain
- Streets

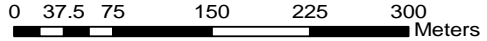

% Gross Infested Area (map 5)

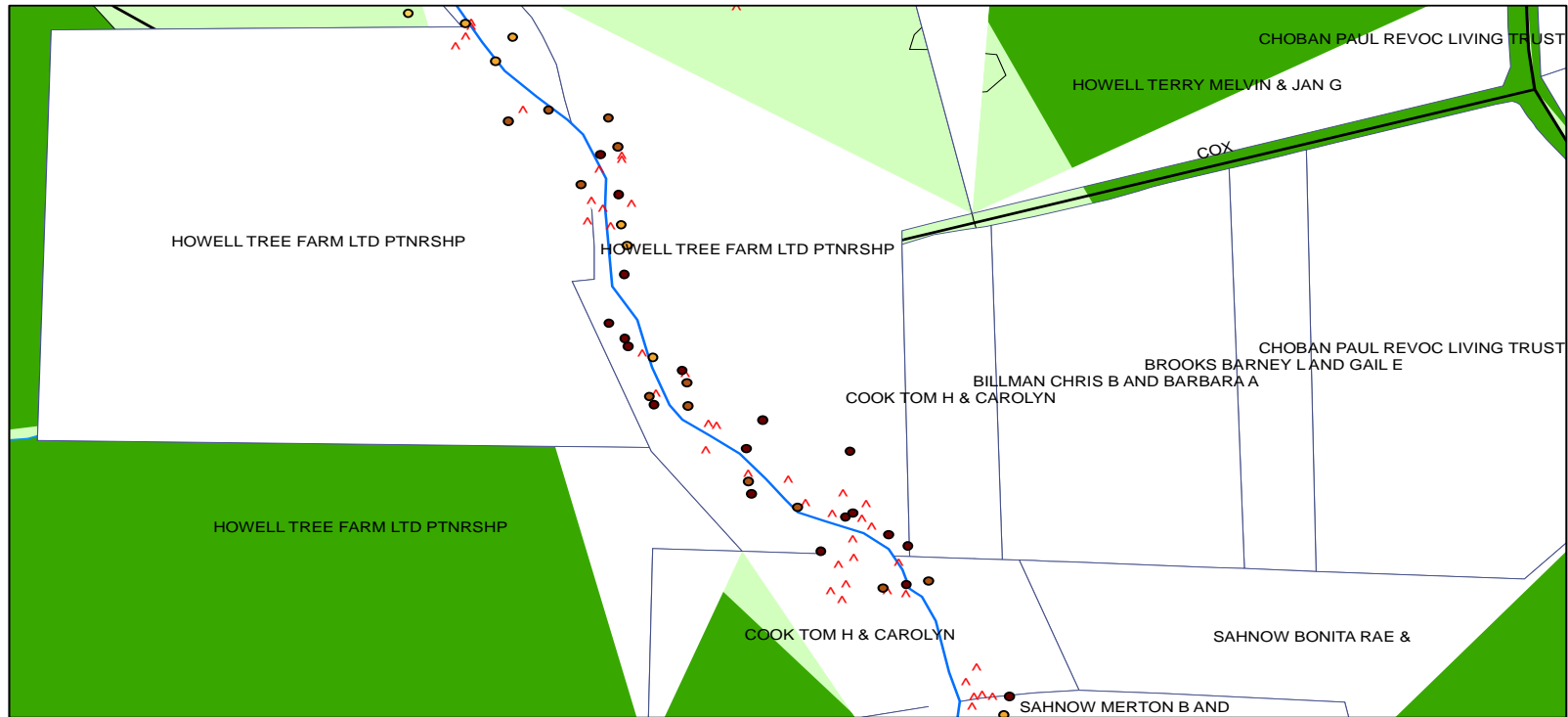

Legend

% Gross Infested Area

- 5 - 20
- 21 - 40
- 41 - 65
- 66 - 85
- 86 - 100
- ▲ Small Patches
- Gales Creek
- Taxlots
- 100 Year Floodplain
- Streets

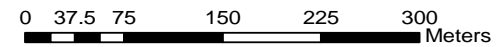

% Gross Infested Area (map 6)

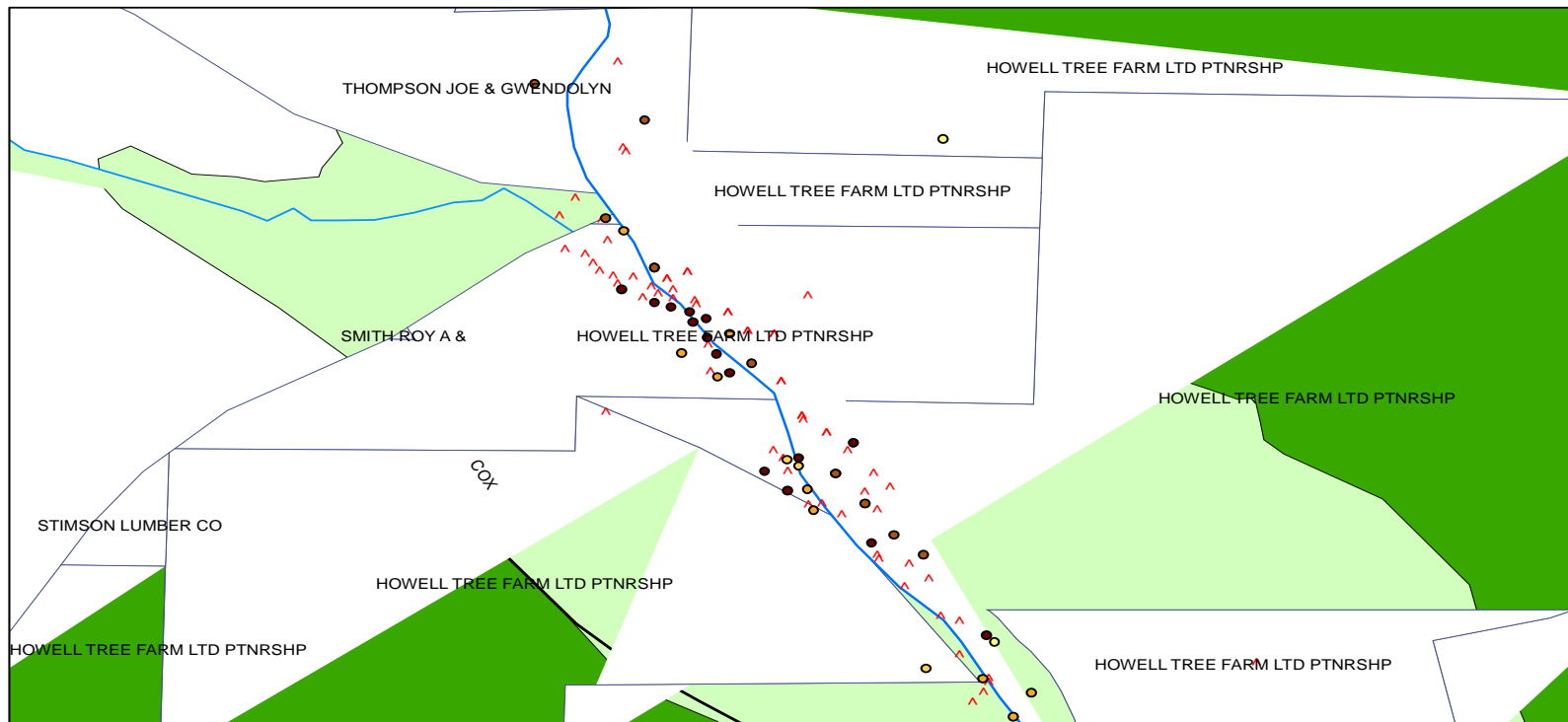

Legend

% Gross Infested Area

- 5 - 20
- 21 - 40
- 41 - 65
- 66 - 85
- 86 - 100
- △ Small Patches
- Gales Creek
- Taxlots
- 100 Year Floodplain
- Streets

0 37.5 75 150 225 300 Meters

% Gross Infested Area (map 7)

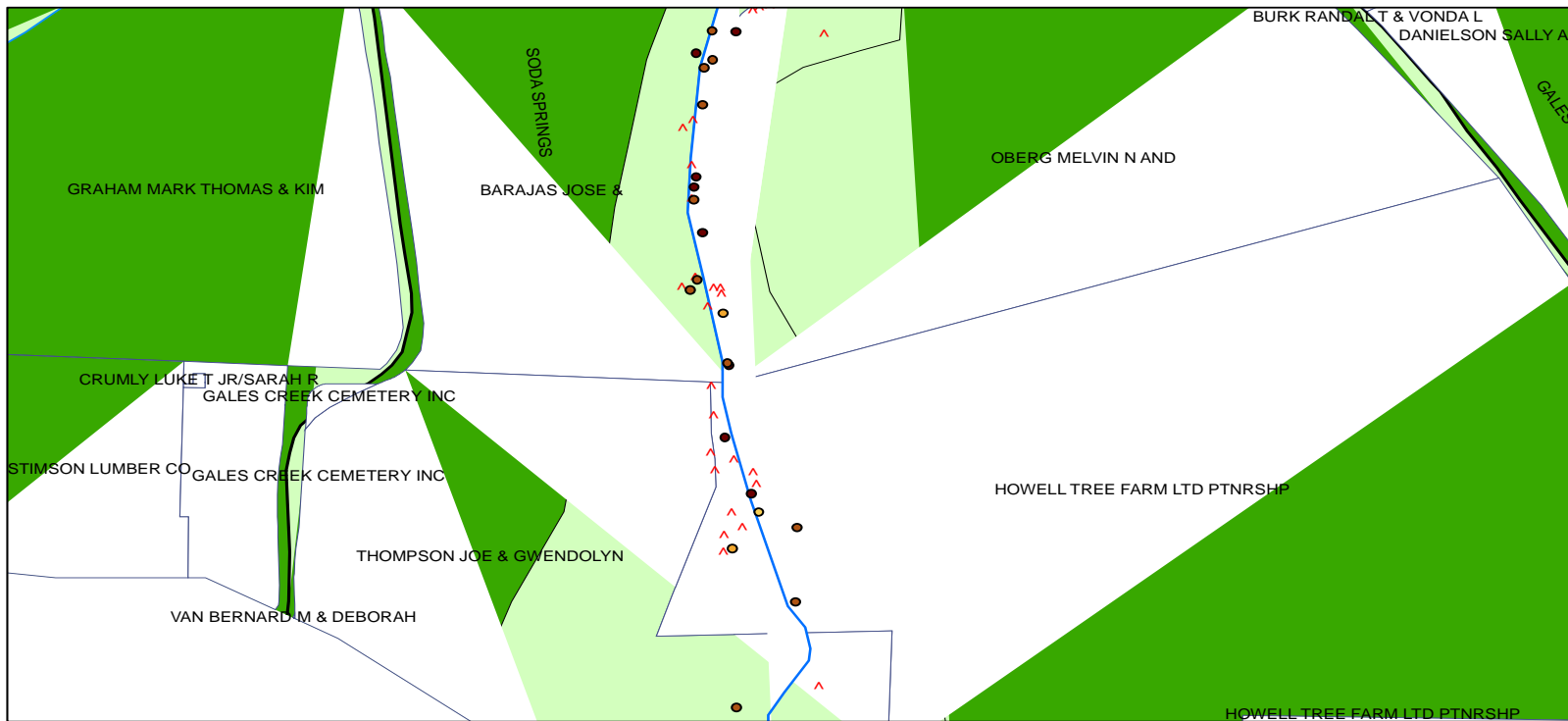

Legend

% Gross Infested Area

- 5 - 20
- 21 - 40
- 41 - 65
- 66 - 85
- 86 - 100
- ▲ Small Patches
- Gales Creek
- Taxlots
- 100 Year Floodplain
- Streets

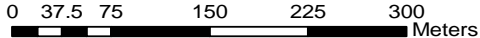

% Gross Infested Area (map 8)

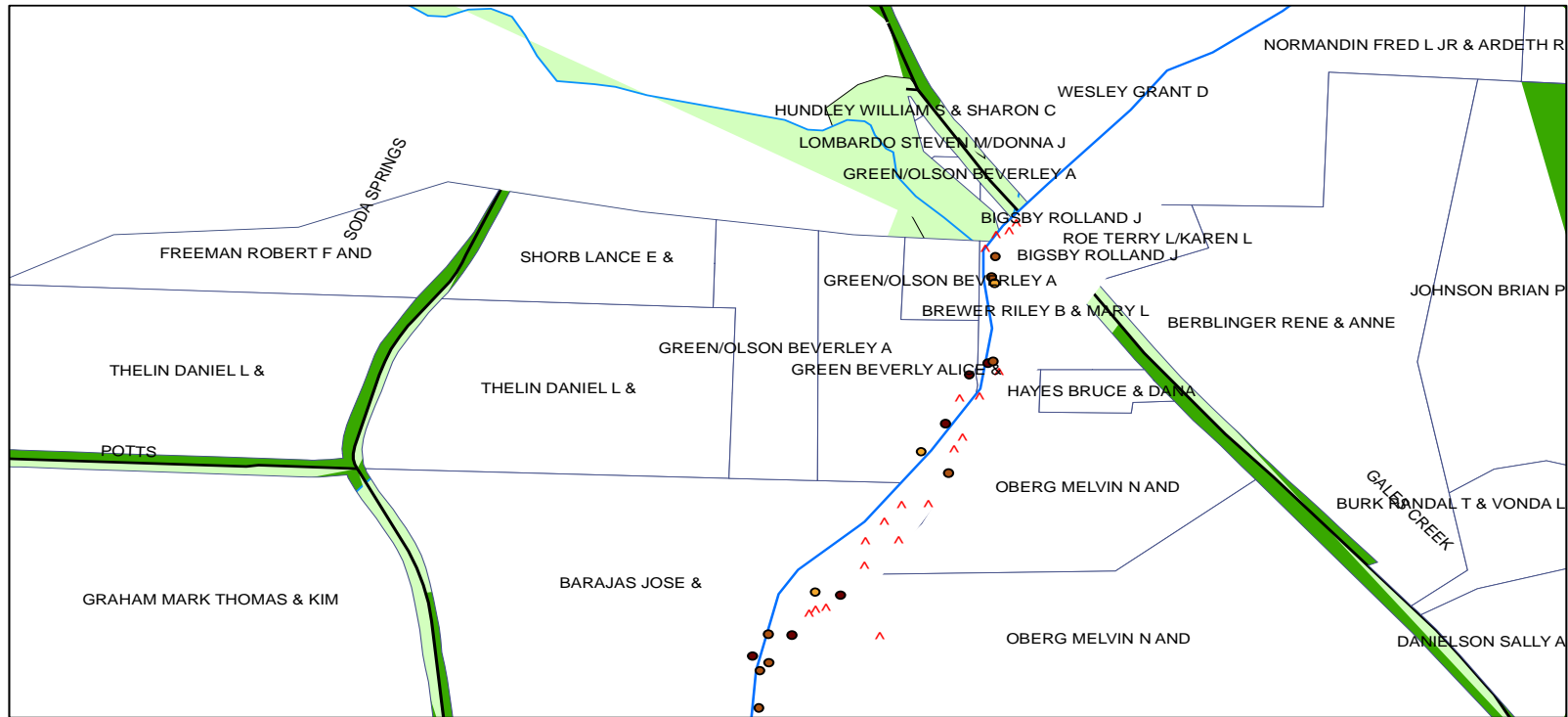

Legend

% Gross Infested Area

- 5 - 20
- 21 - 40
- 41 - 65
- 66 - 85
- 86 - 100
- ▲ Small Patches
- Gales Creek
- Taxlots
- 100 Year Floodplain
- Streets

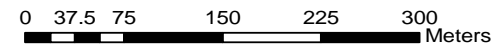

% Gross Infested Area (map 9)

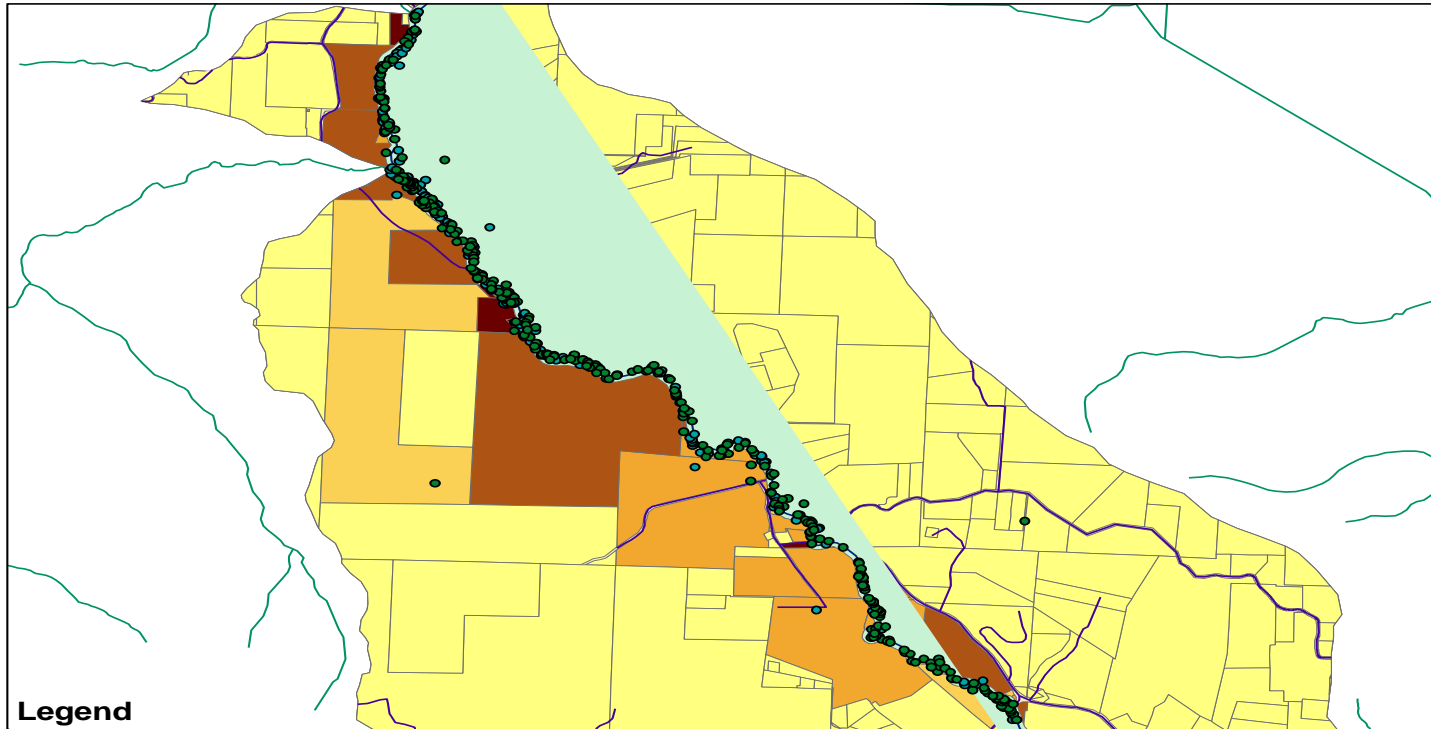

Legend

Avg. Gross Infested Area

Avg_GROSS

- 0.000000 - 20.000000
- 20.000001 - 53.100000
- 53.100001 - 67.500000
- 67.500001 - 81.875000
- 81.875001 - 100.000000

Average Gross Infested Area by Taxlot

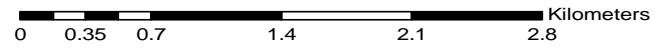

Map describes the average percentage of knotweed infestation in each taxlot along Gales Creek.

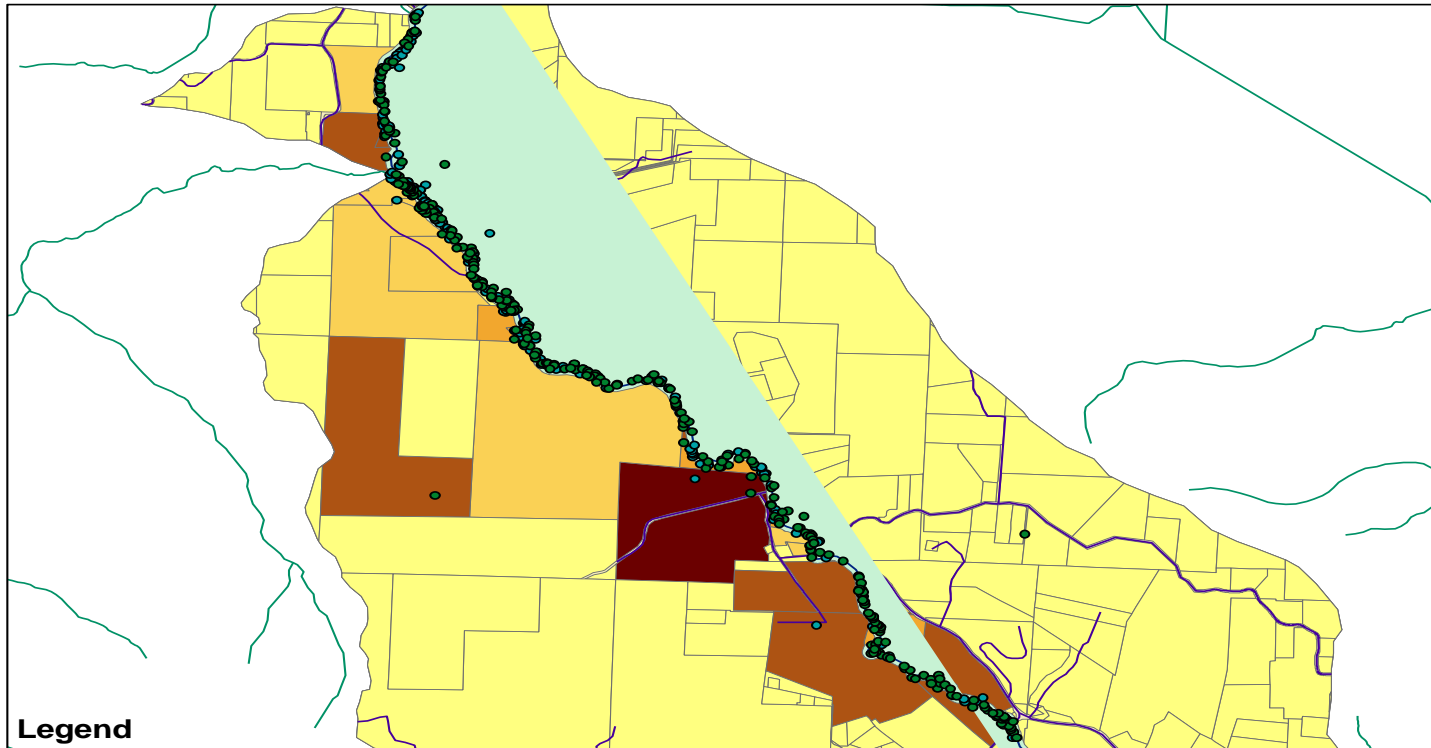

Legend

Avg. Stems

Avg_STEMS

- 0.000000 - 170.000000
- 170.000001 - 695.500000
- 695.500001 - 2420.000000
- 2420.000001 - 6642.500000
- 6642.500001 - 17243.333333

Average Number Stems by Taxlot

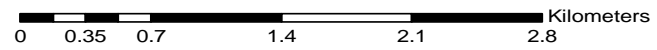

Map shows the average number of knotweed stems in each taxlot.

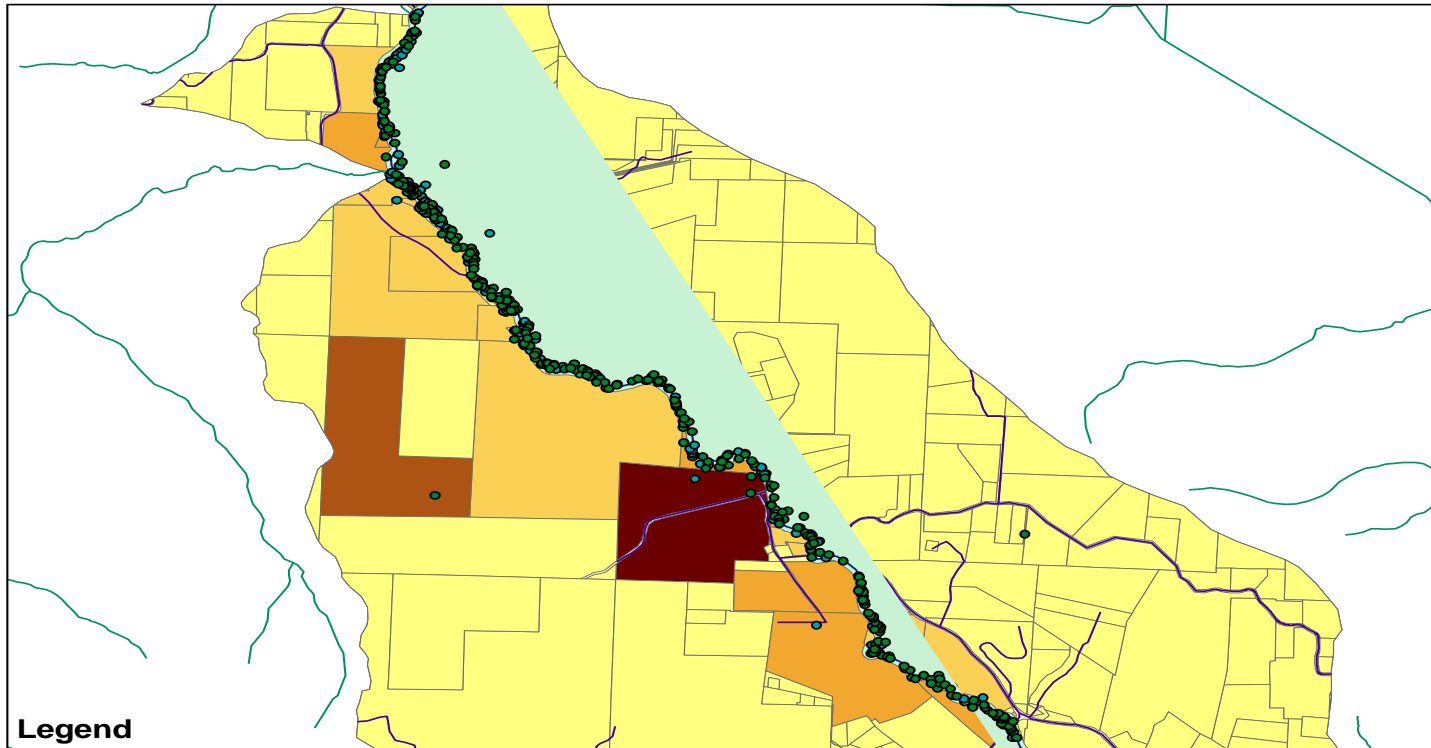

Legend

Avg. Infested Area

Avg_INFESE

- 0.000000 - 58.333333
- 58.333334 - 224.500000
- 224.500001 - 653.333333
- 653.333334 - 1125.000000
- 1125.000001 - 2349.666667

Average Infested Area by Taxlot

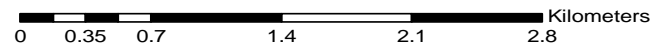

Map shows the average size of infested area in each taxlot.

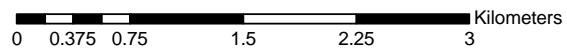
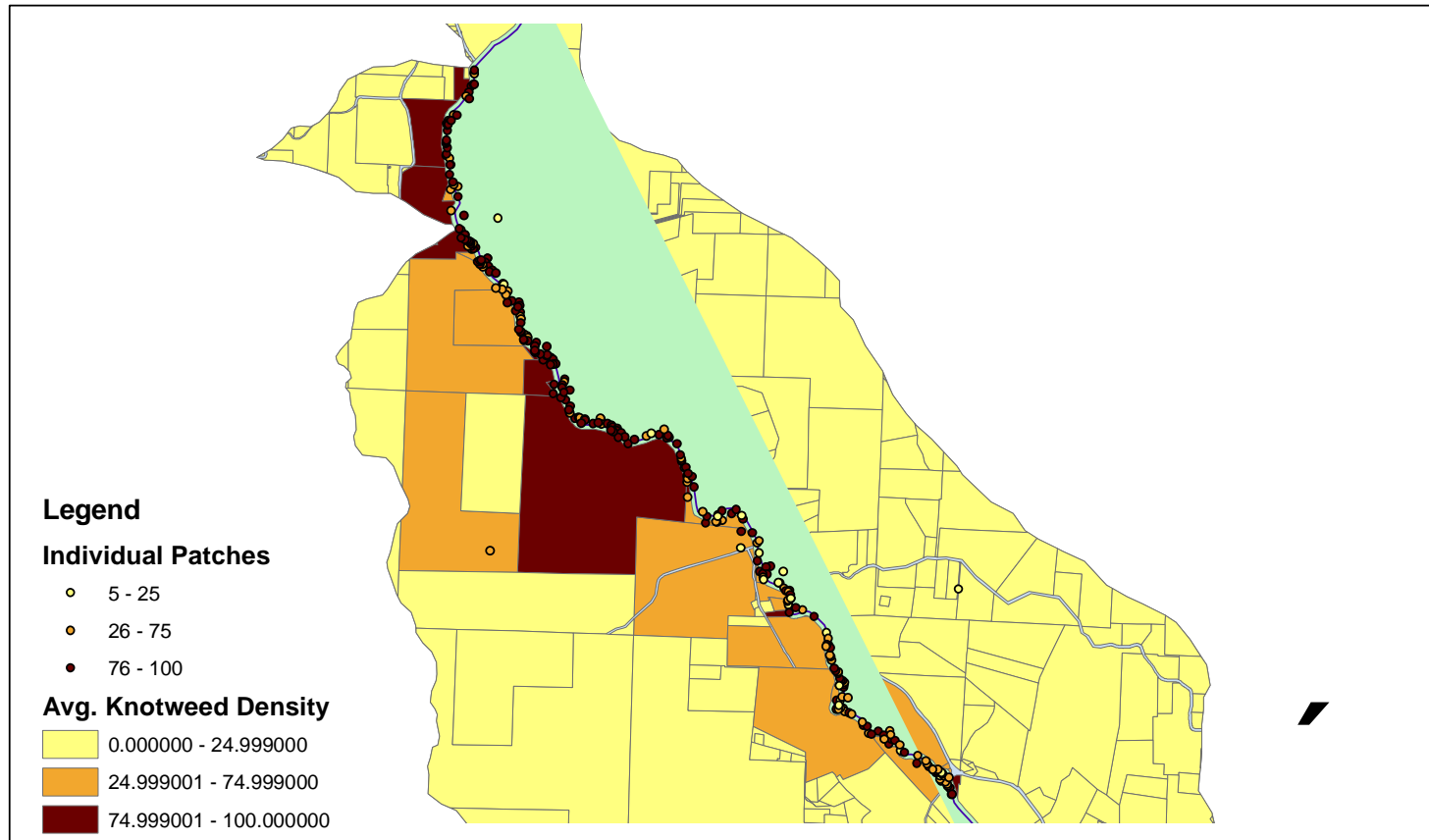

Kotweed Density (classified as Low, Medium, High)

This map shows the distribution of knotweed density in the Gales Creek Study Area. Density is classified as Low, Medium, or High. The Tax Lot information is based on the average density within the tax lot.